

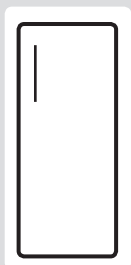

EN

**BUILT IN FREEZER**  
User manual



**BIFZ200**



# Index

<b>BEFORE USING THE APPLIANCE.....</b>	<b>4</b>
General warnings.....	4
Safety warnings .....	6
Installing and operating your freezer .....	7
Electrical connection (For UK type plug) .....	8
Before using your freezer .....	9
Information on No-Frost technology .....	9
<b>THE PARTS OF THE APPLIANCE AND THE COMPARTMENTS .....</b>	<b>10</b>
<b>USAGE INFORMATION .....</b>	<b>11</b>
Control panel .....	11
Freezer partition temperature setting button.....	11
Alarm light.....	11
Super freezer mode .....	11
Freezer temperature settings.....	12
Warnings about temperature adjustments.....	12
Accessories .....	13
Ice tray .....	13
Icematic .....	13
<b>ARRANGING FOOD IN THE APPLIANCE.....</b>	<b>14</b>
<b>CLEANING AND MAINTENANCE.....</b>	<b>16</b>
Defrosting .....	16
Replacing the LED strip.....	17
<b>SHIPMENT AND REPOSITIONING .....</b>	<b>18</b>
<b>BEFORE CALLING YOUR AFTER SALES SERVICE ...</b>	<b>19</b>
Tips for saving energy .....	20
<b>INSTALLATION INSTRUCTIONS AND DOOR REVERSIBILITY.....</b>	<b>21</b>
Installation instructions .....	21
Door reversing .....	24
<b>BELLING CUSTOMER CARE .....</b>	<b>25</b>

## General warnings

**WARNING:** Keep ventilation openings, in the appliance enclosure or in the built-in structure, clear of obstruction.

**WARNING:** Do not use mechanical devices or other means to accelerate the defrosting process, other than those recommended by the manufacturer.

**WARNING:** Do not use electrical appliances inside the food storage compartments of the appliance, unless they are of the type recommended by the manufacturer.

**WARNING:** Do not damage the refrigerant circuit.

**WARNING:** In order to avoid any hazards resulting from the instability of the appliance, it must be fixed in accordance with the following instructions:

- If your appliance uses R600a as a refrigerant (this information will be provided on the label of the cooler) you should take care during transportation and installation to prevent the cooler elements from being damaged. R600a is an environmentally friendly and natural gas, but it is explosive. In the event of a leak due to damage of the cooler elements, move your freezer away from open flames or heat sources and ventilate the room where the appliance is located for a few minutes.
- While carrying and positioning the freezer, do not damage the cooler gas circuit.
- Do not store explosive substances such as aerosol cans with a flammable propellant in this appliance.
- This appliance is intended for domestic use only. Commercial use will nullify the warranty.
- If the socket does not match the freezer plug, it must

be replaced by the manufacturer, a service agent or similarly qualified persons in order to avoid a hazard.

- A specially grounded plug has been connected to the power cable of your freezer. This plug should be used with a specially grounded socket of 16 amperes. If there is no such socket in your house, please have one installed by an authorised electrician.
- This appliance can be used by children aged from 8 years and above and persons with reduced physical, sensory or mental capabilities or lack of experience and knowledge if they have been given supervision or instruction concerning use of the appliance in a safe way and understand the hazards involved. Children shall not play with the appliance. Cleaning and user maintenance shall not be made by children without supervision.
- If the supply cord is damaged, it must be replaced by the manufacturer, an authorised service agent or similar qualified persons, in order to avoid a hazard.
- This appliance is not intended for use at altitudes exceeding 2000 m.

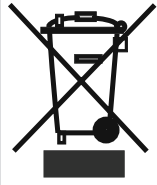

### Old and out-of-order fridges or freezers

- If your old fridge or freezer has a lock, break or remove the lock before discarding it, because children may get trapped inside it and may cause an accident.
- Old fridges and freezers may contain isolation material and refrigerant with CFC or HFC. Therefore, take care not to harm environment when you are discarding your old fridges or freezers.

Please ask your municipal authority about the disposal of the WEEE reuse, recycle and recovery purposes.

### Notes:

- Please read the instruction manual carefully before installing and using your appliance. **We are not responsible for the damage occurred due to misuse.**
- Follow all instructions on your appliance and instruction manual, and keep this manual in a safe place to resolve the problems that may occur in the future.
- This appliance is produced to be used in homes and it can only be used in domestic environments and for the specified purposes. It is not suitable for commercial or common use. Such use will cause the guarantee of the appliance to be cancelled and our company will not be responsible for losses incurred.
- This appliance is produced to be used in houses and it is only suitable for cooling / storing food. It is not suitable for commercial or common use and/or for storing substances except for food. Our company is not responsible for losses to be incurred in the contrary case.

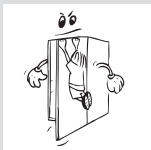

### Safety warnings

- Do not use multiple receptacles or extension cord.
- Do not plug in damaged, torn or old plugs.
- Do not pull, bend or damage the cord.



- This appliance is designed for use by adults, do not allow children to play with the appliance or let them to hang over the door.
- Do not plug-in or out the plug from the receptacle with wet hands to prevent electrocution!

- Do not place glass bottles or beverage cans in the freezer. Bottles or cans may explode.
- Do not place explosive or flammable material in your freezer for your safety. Place drinks with higher alcohol amount vertically and by closing their necks tightly in the freezer.
- When taking ice made in the freezer, do not touch it, ice may cause ice burns and/or cuts.
- Do not touch frozen goods with wet hands! Do not eat ice-cream and ice cubes immediately after you take them out of the freezer!
- Do not re-freeze the frozen goods after being melted. This may cause health issues like food poisoning.
- Do not cover the body or top of freezer with lace. This affects the performance of your freezer.
- Fix the accessories in the freezer during transportation to prevent damage to accessories.



### Installing and operating your freezer

*Before starting to use your freezer, you should pay attention to the following points:*

- Operating voltage for your freezer is 220-240 V at 50Hz.
- We do not take the responsibility of the damages that occur due to ungrounded usage.
- Place your freezer in a place that it would not be exposed to direct sunlight.
- Your appliance should be at least 50 cm away from stoves, Gas ovens and heater cores, and should be at least 5 cm away from electrical ovens.
- Your freezer should never be used outdoors or left under the rain.
- When your freezer is placed next to a deep freezer, there should be at least 2 cm between them to prevent humidity on the outer surface.
- Do not place heavy items on the appliance.
- Do not place anything on your freezer, and install your freezer in a suitable place so that at least 15 cm is available on the upper side.
- The adjustable front legs should be stabilized in an appropriate height to allow your freezer operate in a stable and proper way. You can adjust the legs by turning them clockwise (or in the opposite direction). This should be done before placing food in the freezer.
- Before using your freezer, wipe all parts with warm water added



with a tea spoonful of sodium bicarbonate, and then rinse with clean water and dry. Place all parts after cleaning.

- Install the distance adjustment plastic (the part with black vanes at the rear) by turning it 90° as shown in the figure to prevent the condenser from touching the wall.
- Freezer should be placed against a wall with a free distance not exceeding 75 mm.

### Electrical connection (For UK type plug)

For your safety please read the following information

#### Warning: This appliance must be earthed.

This appliance operates from 220-240 volts and should be protected by a 13 amp fuse in the plug.

The appliance is supplied with a standard 13 amp 3-pin mains plug fitted with a 13-amp fuse. Should the fuse require replacement, it must be replaced with a fuse rated at 13 amp and approved to BS1362.

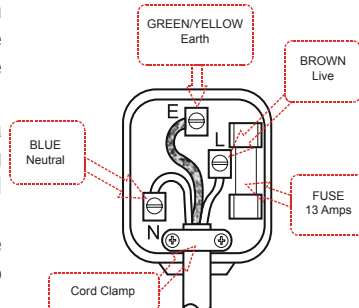

If the mains plug which is fitted is unsuitable for the socket outlet in your home or is removed for any other reason, please follow the instructions below on how to wire a 13 amp 3 pin plug..

#### How to wire a 13 amp plug.

##### Important

The wires in the mains lead on this appliance are coloured in accordance with the following code:

Green and Yellow - Earth

Blue – Neutral

Brown – Live

As the colours may not correspond with the markings identifying the terminals in your plug proceed as follows.

The green and yellow wire must be connected to the terminal in the plug which is marked with the letter E or with the earth symbol  $\equiv$  or coloured green and yellow.

The blue wire must be connected to the terminal marked N.

The brown wire must be connected to the terminal marked L.

You must make sure the lead is firmly secured under the cord clamp.

### Before using your freezer

- When it is operated for the first time or after transportation, keep your freezer in the upright position for 3 hours and plug it on to allow efficient operation. Otherwise, you may damage the compressor.
- Your freezer may have a smell when it is operated for the first time; the smell will fade away when your freezer starts to cool.

### Information on No-Frost technology

No-frost freezers differ from other static freezers in their operating principle.

In normal freezers, the humidity entering the freezer due to opening the door and the humidity inherent in the food causes freezing in the freezer compartment. To defrost the frost and ice in the freezer compartment, you are periodically required to turn off the freezer, place the food that needs to be kept frozen in a separately cooled container and remove the ice gathered in the freezer compartment.

The situation is completely different in no-frost freezers. Dry and cold air is blown into the fridge and freezer compartments homogeneously and evenly from several points via a blower fan. Cold air dispersed homogeneously and evenly between the shelves cools all of your food equally and uniformly, thus preventing humidity and freezing.

Therefore your no-frost freezer allows you ease of use, in addition to its huge capacity and stylish appearance.

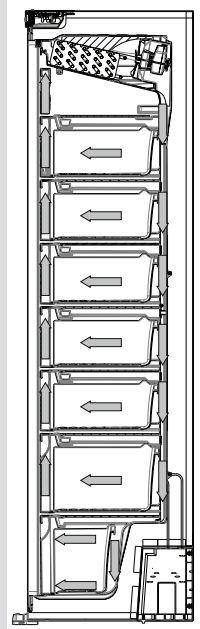
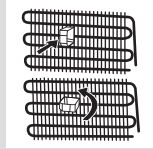

## THE PARTS OF THE APPLIANCE AND THE COMPARTMENTS

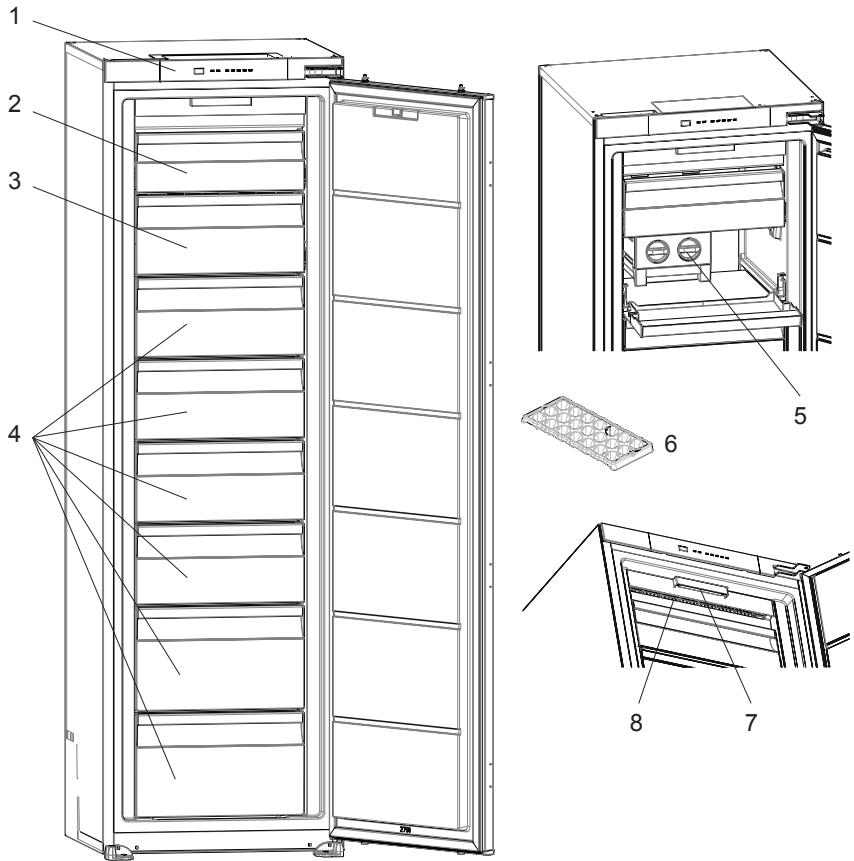

This presentation is only for information about the parts of the appliance.  
Parts may vary according to the appliance model.

1. Control panel
2. Freezer upper room cover
3. Freezer compartment drawers / freezer room cover \*
4. Freezer compartment drawers
5. Ice matic \*
6. Ice tray \*
7. Freezer LED strip \*
8. No Frost air circulation system

\* In some models

## Control panel

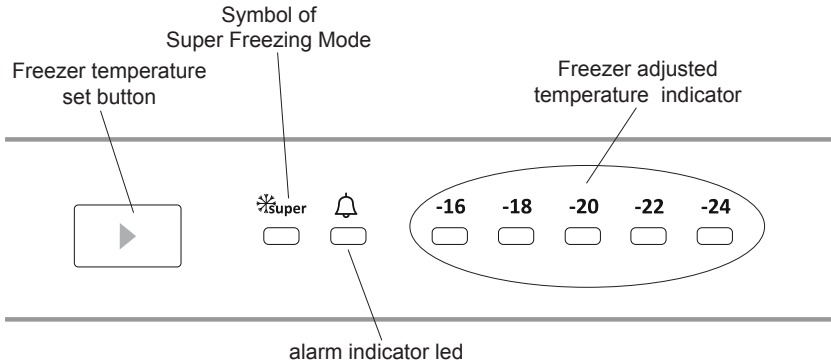

### Freezer partition temperature setting button

This button allows setting temperature of the freezer. In order to set values for freezer partition, press this button. Use this button also to activate SF mode.

### Alarm light

In case of a problem within the freezer, the alarm led will release red light

### Super freezer mode

#### When would it be used?

- To freeze huge quantities of food.
- To freeze fast food.
- To freeze food quickly.
- To store seasonal food for a long time.

#### How to use?

- Press temperature set button until super freezing light comes on.
- Super freezing led will light during this mode.
- Maximum amount of fresh food (in kilograms) to be frozen within 24 hours is shown on the appliance label.
- For optimal appliance performance in maximum freezer capacity, set the appliance to active SF mode 24 hours before you put the fresh food into the freezer.

#### During this mode:

If you press temperature set button, the mode will be cancelled and the setting will be restored from -16.

**Note:** "Super Freezer" mode will be automatically cancelled after 24 hours or when freezer sensor temperature drops beneath -32 °C.

### Freezer temperature settings

- The initial temperature of the Setting Display is  $-18^{\circ}\text{C}$ .
- Press freezer setting button once.
- Every time you press the button, the setting temperature will decrease. ( $-16^{\circ}\text{C}$ ,  $-18^{\circ}\text{C}$ ,  $-20^{\circ}\text{C}$ ,... super freezing)
- If you press freezer setting button until super freezer symbol is displayed on Freezer

Settings Display and you do not press any button within the following 3 seconds, Super Freezing will blink.

- If you keep on pressing, it will restart from last value.

### Warnings about temperature adjustments

- Your temperature adjustments will not be deleted when an energy breakdown occurs.
- Do not pass to another adjustment before completing an adjustment
- Temperature adjustments should be made according to the frequency of door openings, the quantity of food kept inside the freezer and ambient temperature of the place of your freezer.
- Your freezer should be operated up to 24 hours according to the ambient temperature without interruption after being plugged in to be completely cooled.
- Do not open doors of your freezer frequently and do not place much food inside it in this period.
- A 5 minute delaying function is applied to prevent damage to the compressor of your freezer, when you take the plug off and then plug it on again to operate it or when an energy breakdown occurs. Your freezer will start to operate normally after 5 minutes.
- Your freezer is designed to operate in the ambient temperature intervals stated in the standards, according to the climate class stated in the information label. We do not recommend operating your freezer out of stated temperatures value limits in terms of cooling effectiveness.
- This appliance is designed for use at an ambient temperature within the  $10^{\circ}\text{C}$  -  $43^{\circ}\text{C}$  range.

Climate class	Ambient temperature ( $^{\circ}\text{C}$ )
T	Between 16 and 43 ( $^{\circ}\text{C}$ )
ST	Between 16 and 38 ( $^{\circ}\text{C}$ )
N	Between 16 and 32 ( $^{\circ}\text{C}$ )
SN	Between 10 and 32 ( $^{\circ}\text{C}$ )

## Accessories

### Ice tray (In some models)

- Fill the ice tray with water and place in freezer.
- After the water completely turned into ice, you can twist the tray as shown below to get the ice cube.

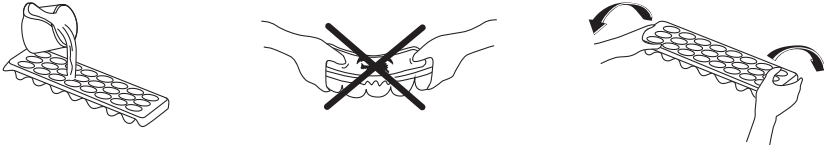

### Icematic (In some models)

- Take out the ice making tray
- Fill the water in level of line.
- Place the ice making tray in its original position
- When ice cubes are formed, twist the lever to drop off ice cubes into the icebox.

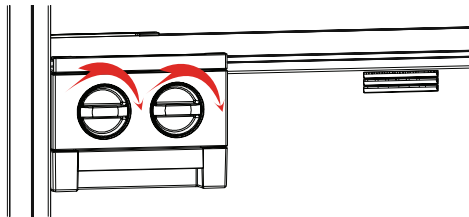

#### Note:

- Do not fill the icebox with water in order to make ice. It can be broken.
- The movement of the ice maker may be difficult while the freezer is running. In such a case should be cleaned by removing the glass shelves.

### Removing the Ice maker

- Take out of the freezer glass shelves
- Remove the icemaker by dragging left or right on the shelf.

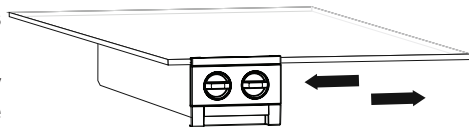

You can remove the icemaker to use a larger volume of the freezer.

Visual and text descriptions on the accessories section may vary according to the model of your appliance.

- Use your freezer to keep frozen food for a long time and to produce ice.
- Do not place food you want to freeze next to frozen food.
- You should freeze your food (meat, minced meat, fish etc) in portions that allow consuming in a time.
- Do not put fresh and warm food with frozen food side by side as it can thaw the frozen food.
- While freezing fresh food (i.e. meat, fish and mincemeat) divide them in parts in order to use in one time.
- For storing the frozen food; the instructions shown on frozen food packages should always be followed carefully and if no information is provided, food should not be stored for more than 3 months from the purchased date.
- Maximum load; if you want to load large quantities and use the maximum net capacity, you can remove the drawers (Except the bottom one). You can store bulky items directly on the shelves.
- When buying frozen food ensure that these have been frozen at suitable temperatures and that the packing is intact.
- Frozen food should be transported in appropriate containers to maintain the quality of the food and should be returned to the freezing surfaces of the unit in the shortest possible time.
- If a package of frozen food shows the sign of humidity and abnormal swelling it is probable that it has been previously stored at an unsuitable temperature and that the contents have deteriorated.
- The storage life of frozen food depends on the room temperature, thermostat setting, how often the door is opened, the type of food and the length of time required to transport the product from the shop to your home. Always follow the instructions printed on the package and never exceed the maximum storage life indicated.
- If you would use maximum freezing capacity of your freezer
- Take the frozen food in the upper basket to other baskets and activate “Fast Freezing” mode. “Fast Freezing” mode will be deactivated automatically after 24 hours. Place the food you want to freeze to the upper basket of the freezer without exceeding the freezing capacity of your freezer. (Your freezer has the capacity to freeze 15 kg at 25°C and 14 kg at 32°C) Then reactivate the “Fast Freezing” mode. You can put your food next to other frozen food after they are frozen (minimum 24 hours after “Fast Freezing” mode is activated for the 2nd time).
- If you would freeze about 3 kg food in your freezer:
- You can place your food without touching other frozen food and activate “Fast Freezing” mode. You can put your food next to other frozen food after they are frozen (after minimum 24 hours).
- Do not re-freeze the frozen goods after being melted. This may cause health issues like food poisoning.

- Do not place hot food to the freezer before cooling them. This may cause the spoiling of food frozen before in the freezer.
- When you are buying frozen food, make sure that they frozen in proper conditions and the package is undamaged.
- Follow the instructions for storing conditions on the package of the frozen food while storing them. If there is no explanation, food must be consumed in a short time.
- If the package of frozen food is humid and smells bad, it may be stored under inappropriate conditions and spoiled. Do not buy this kind of food!
- Storing time for frozen food may differ according to the ambient temperature, frequency of door openings, thermostat adjustments, type of food and the time between the buying of the food and placing of the food in the freezer. Always follow instructions on the package and do not exceed storing period.

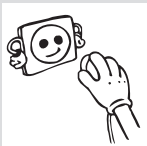

- **Disconnect the unit from the power supply before cleaning.**

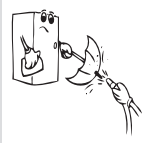

- Do not clean the appliance by pouring water.

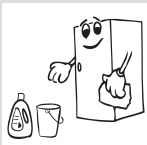

- Make sure that no water enters the lamp housing and other electrical components.

- The freezer should be cleaned periodically using a solution of bicarbonate of soda and lukewarm water.



- Clean the accessories separately with soap and water. Do not clean them in the dishwasher.

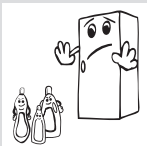
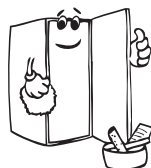

- Do not use abrasive products, detergents or soaps. After washing, rinse with clean water and dry carefully. When you have finished cleaning, reconnect the plug to the mains supply with dry hands.

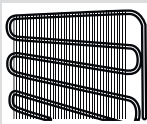

- Clean the condenser with a broom at least twice a year. This will help you to save on energy costs and increase productivity.

### THE POWER SUPPLY MUST BE DISCONNECTED.

### Defrosting

Your freezer defrosts automatically. Water produced by defrosting flows to evaporating container passing through water collecting groove, and vaporizes here by itself.



### Replacing the LED strip

1 led strip in freezer is used to illuminate your appliance. Please call the service man.

**Note:** Numbers and location of led strips may be changed according to the model.

**!!! Some versions may be without illumination.**

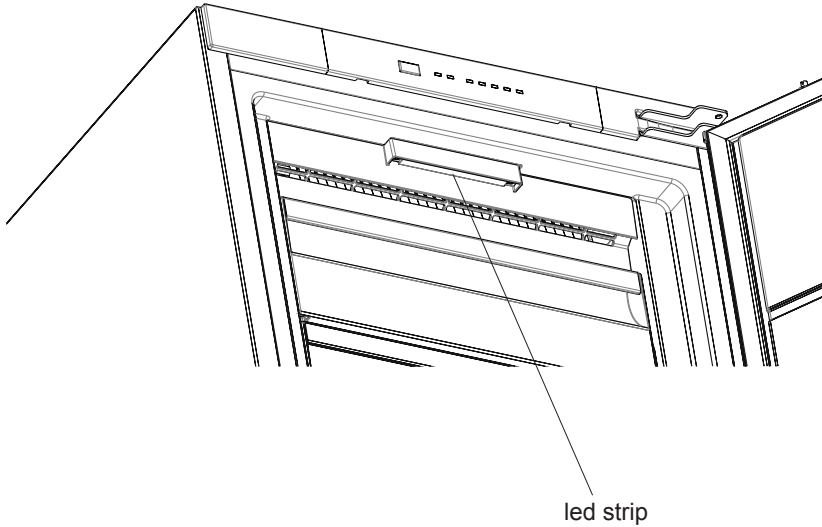

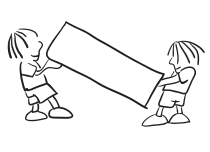

### Transportation and changing of installation position

- The original packages and foamed polystyrene (PS) can be retained if required.
- During transportation, the appliance should be secured with a wide string or a strong rope. The instructions written on the corrugated box must be followed while transporting.
- Before transporting or changing the installation position, all the moving objects (ie, drawer, Ice trays, ...) should be taken out or fixed with bands in order to prevent them from getting damaged.

Carry your freezer in the upright position.

Alarm indicator led is turning on	ERROR TYPE	WHY	WHAT TO DO
	"Failure Warning"	There is/are some part(s) Out of order or there is a failure in cooling process	Check the door is open or not. If the door is not open, call service for assistance as soon as possible.

If your freezer is not working properly, it may be a minor problem, therefore check the following, before calling an electrician to save time and money.

**What to do if your appliance does not operate;**

**Check that;**

- There is no power,
- The general switch in your home is disconnected ,
- The socket is not sufficient. To check this, plug in another appliance that you know which is working into the same socket.

**What to do if your appliance performs poorly;**

**Check that;**

- You have not overloaded the appliance ,
- The freezer temperature set to -16.
- The doors are closed perfectly ,
- There is no dust on the condenser ,
- There is enough place at the rear and side walls.

**If your freezer is operating too loudly;**

**Normal Noises**

**Cracking (Ice cracking) Noise:**

- During automatic defrosting.
- When the appliance is cooled or warmed (due to expansion of appliance material).

**Short cracking:** Heard when the thermostat switches the compressor on/ off.

**Compressor noise: Normal motor noise.** This noise means that the compressor operates normally Compressor may cause more noise for a short time when it is activated.

**Bubbling noise and splash:** This noise is caused by the flow of the refrigerant in the tubes of the system.

**Water flow noise:** Normal flow noise of water flowing to the evaporation container during defrosting. This noise can be heard during defrosting.

**Air Blow Noise:** Normal fan noise. This noise can be heard in No-Frost freezer during normal operation of the system due to the circulation of air.

**If the edges of freezer cabinet that the door joint contact are warm;**

Especially in summer (hot weather), the surfaces that the joint contact may get warmer during the operation of the compressor, this is normal.

**If humidity builds up inside the freezer;**

- Are all food packed properly? Are the containers dried before placing them in the freezer?
- Is the freezers door opened frequently? Humidity of the room gets in the freezer when the doors are opened. Humidity build up will be faster when you open the doors more frequently, especially if the humidity of the room is high.

**If the door is not opened and closed properly;**

- Do the food packages prevent closing of the door?
- Are the drawers placed properly?
- Are door joints broken or torn?
- Is your freezer on a level surface?

**Recommendations**

- To stop the appliance completely, unplug from main socket (for cleaning and when the door is left open)

**Tips for saving energy**

1. Install the appliance in a cool, well ventilated room , but not in direct sunlight and not near a heat source (radiator, cooker.. etc). Otherwise use an insulating plate.
2. Allow warm food and drinks to cool down outside the appliance.
3. Cover drinks or other liquids when placing them in the appliance Otherwise humidity increases in the appliance. Therefore, the working time gets longer. Also covering drinks and other liquids helps to preserve smell and taste.
4. Try to avoid keeping the doors open for long periods or opening the doors too frequently as warm air will enter the cabinet and cause the compressor to switch on unnecessarily often.
5. Keep the covers of the different temperature compartments (crisper, chiller ...etc ) closed
6. Door gasket must be clean and pliable. Replace gaskets if worn.

### Installation instructions

- ! Before installation, read the instructions carefully.
  - ! Fit the refrigerator/freezer in stable kitchen units only.
  - ! If necessary, reverse the door according to instructions.
1. See fig.A for the necessary attachment components.
  2. Insert trim **flap**<sup>1</sup> into slot and screw by **screws**<sup>6</sup>. (fig.D)
  3. Pass the power cord through ventilation shaft and position it so that the appliance could be easily plugged in once it has been installed. (fig.B - fig.C)
  4. Take out the **trim gasket**<sup>4</sup> located on the side panel of the appliance and stick it on reverse side of the door hinges of the appliance. (fig.D - fig.E)
  5. Raise the appliance and slide into the kitchen unit.
  6. Push the appliance to the reverse side of the door hinges providing that the **trim gasket**<sup>2</sup> covers the space between the appliance and the kitchen unit.
  7. Align the front feet with front surface of the kitchen unit. (fig.F)
  8. Screw the front feet by using **screws**<sup>5</sup>. (fig.F)
  9. Screw **trim flap**<sup>1</sup> to kitchen unit using **screws**<sup>5</sup>. (fig.G)
  10. Screw **guides**<sup>3</sup> to appliance door with **screws**<sup>6</sup>. (fig.H)
  11. Lean appliance door to unit door as it is opened at right angle.
  12. Slide **rails**<sup>4</sup> into **guides**<sup>3</sup> aligning the **groove**. (fig.H)
  13. Screw the **rails**<sup>4</sup> to the unit door with **screws**<sup>5</sup>. (fig.H)
  14. Set 1~2 mm gap on handle side between unit itself and unit door by adjusting **guides**<sup>3</sup>. That is vital for appliance performance. (fig.H)

# INSTALLATION INSTRUCTIONS AND DOOR REVERSIBILITY

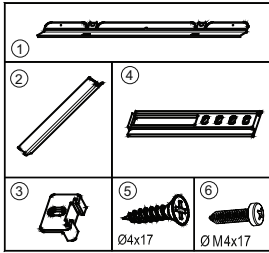

Figure.A

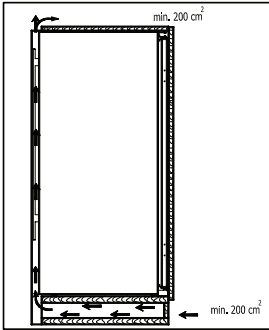

Figure.B

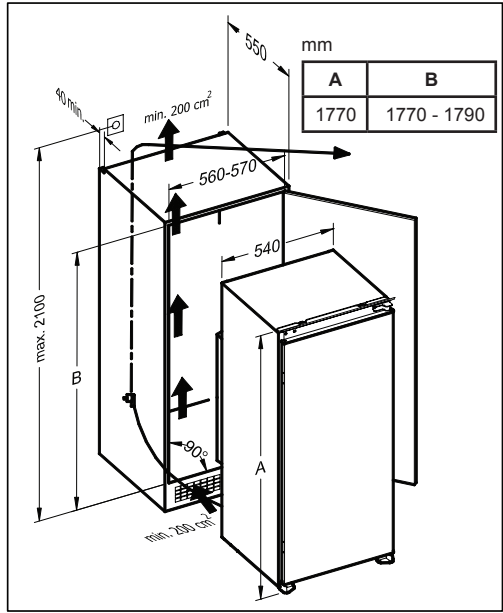

Figure.C

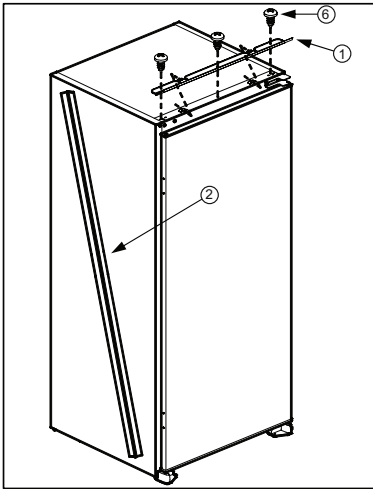

Figure.D

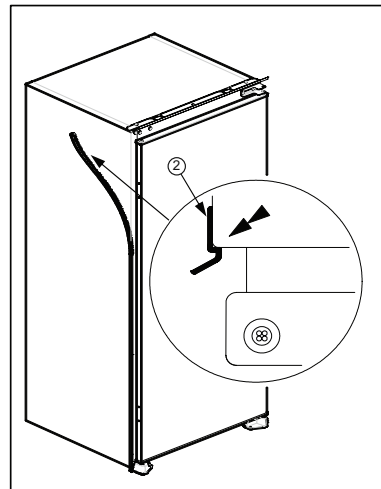
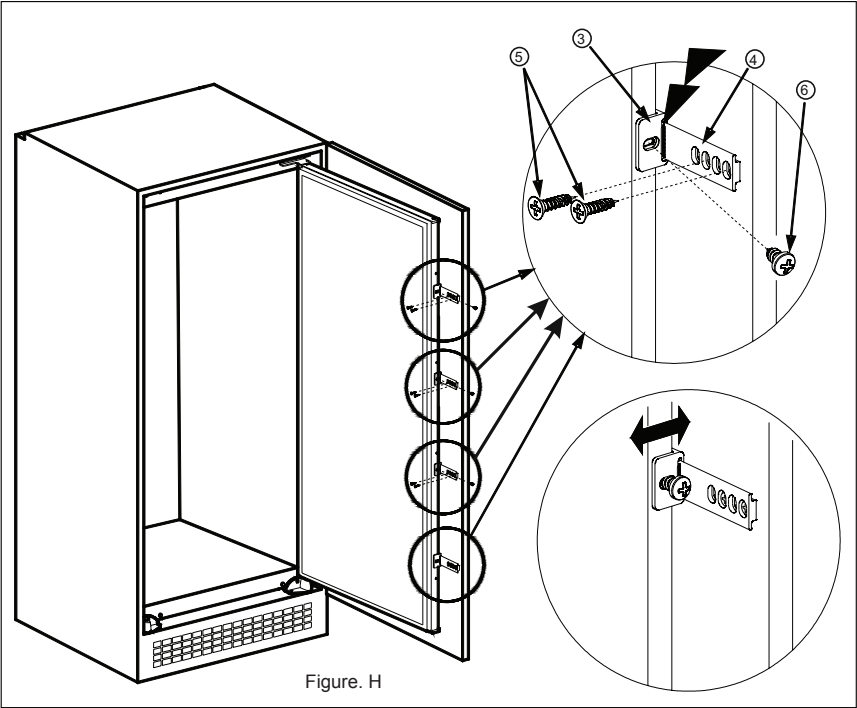
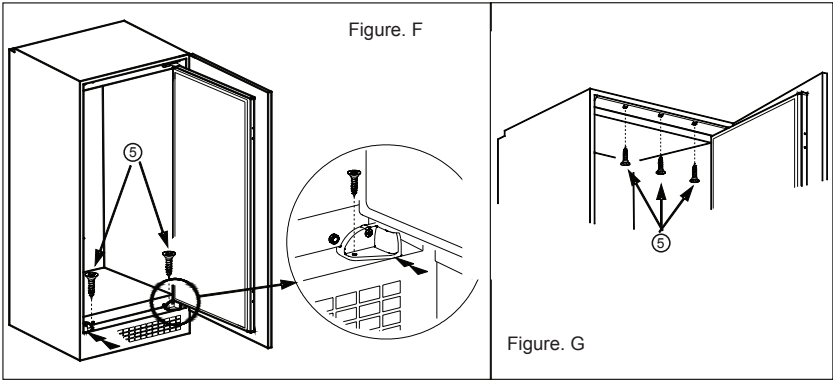
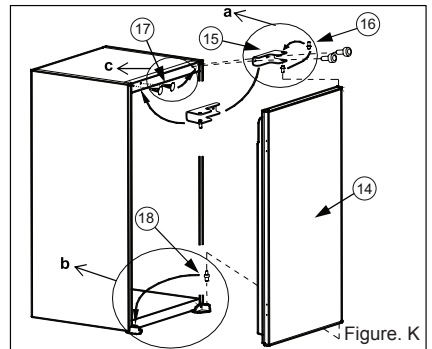
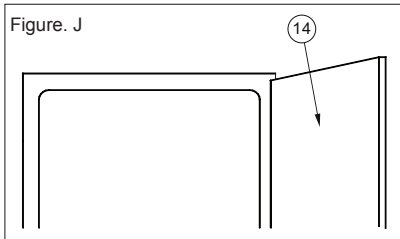

Figure.E





## Door reversing

1. Open **appliance door**<sup>14</sup>. (fig.J)
2. Disassemble **door hinge**<sup>15</sup> and take **appliance door**<sup>14</sup> to safe place. (fig.K)
3. Unscrew **door hinge pin**<sup>16</sup> and screw it to opposite side firmly and take to safe place. (fig.K.a)
4. Take **door lower pin**<sup>18</sup> to opposite side. (fig.K.b)
5. Take **hole plugs**<sup>17</sup> to opposite side. (fig.K.c)
6. Place **appliance door**<sup>14</sup> over **door lower pin**<sup>18</sup> and insert **door hinge pin**<sup>16</sup> into hinge hole on **appliance door**<sup>14</sup> and then screw **door hinge**<sup>15</sup> firmly onto opposite side of original position. (fig.K)

Please keep this handbook in a safe place.

Please fill in the model number  
and serial number in the spaces provided below as they will assist us should you  
need to call.

**01 8428222**

When you dial this number you will hear a recorded message and be given a  
number of options. This indicates that your call has been accepted and is being  
held in a queue. Calls are answered in strict rotation as our Customer Care  
Representatives become available.

Enter appliance numbers here for future reference:

Model no

--	--	--	--	--	--	--	--	--	--

Serial no

--	--	--	--	--	--	--	--





CE

52204806