

## DOOR GASKET CHANGE

Pull the gasket towards starting from top right corner  
Slowly pull the rest of the gasket.  
Completely remove the gasket from door.

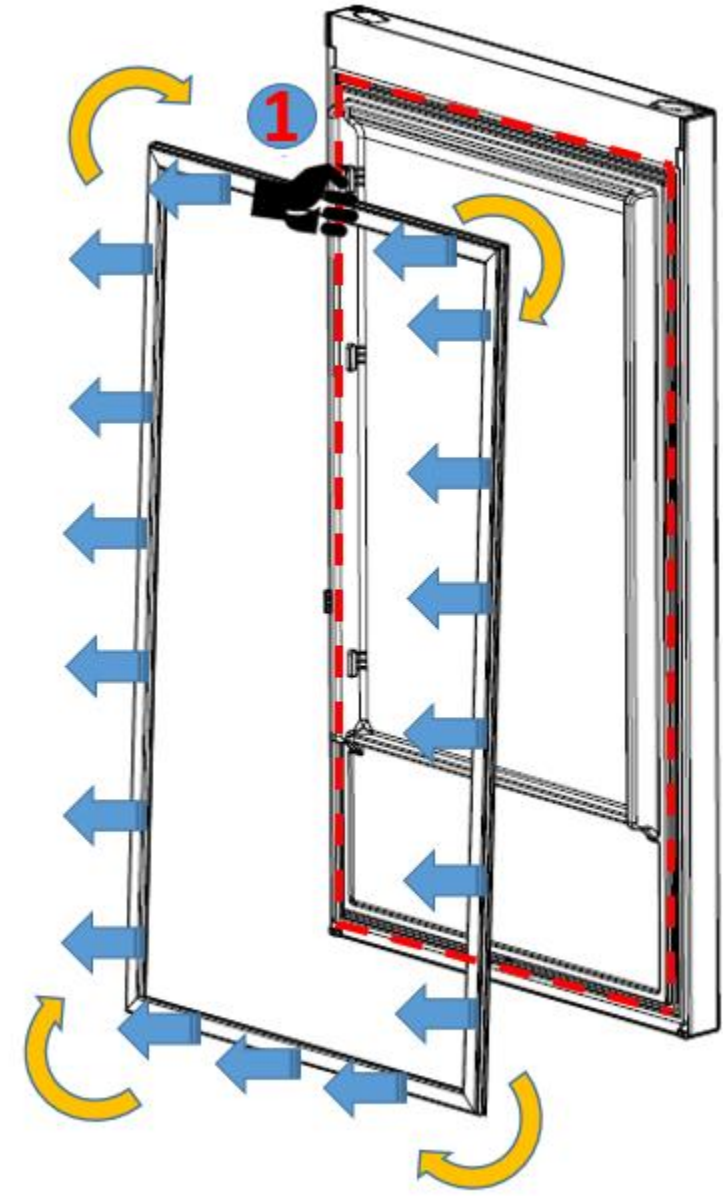

Check the replacement gasket form  
Starting with upper right corner, press on the gasket until it fits to its place..  
Place the other sides of the gasket with the help of your thumb

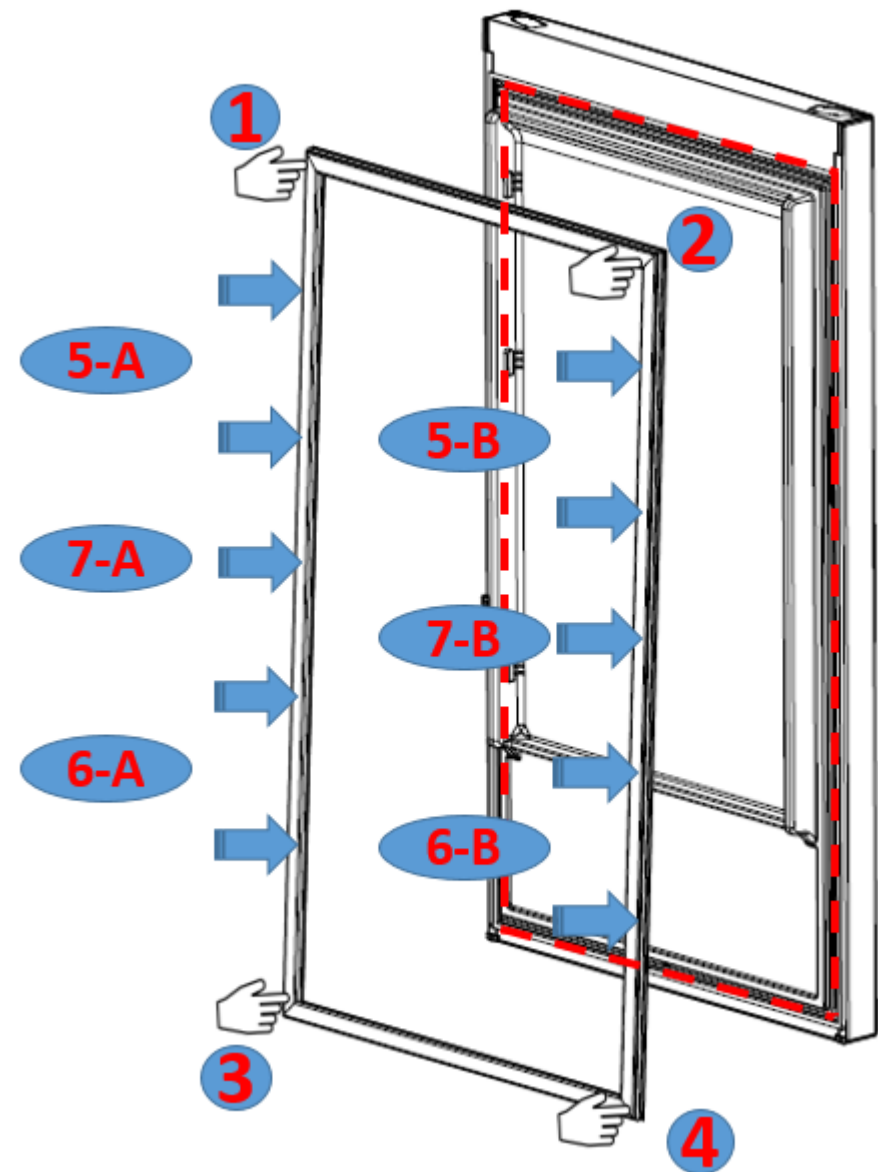

After the replacement check if there any non-fitting point on the gasket. Also check if there any opening at the gasket while the door is closed. If so that might cause condensation/icing or insufficient cooling/freezing. To prevent this soften the form of the gasket with the help of a hair dryer or hot water and make sure that all points are closing perfectly.